

USER MANUAL OF FINGERPRINT DOOR LOCK

Thanks for use Tengo locks:

Please read this user manual carefully before use.



Please keep well this manual for future query.

To know more about our new products and service, please visit us at : <http://www.tengolock.com>

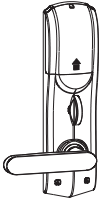
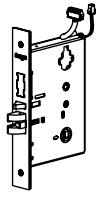
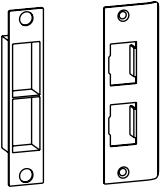

■ Packing List |

Please check the packing before use.

 <p>Front Panel</p>	 <p>Back Panel</p>	 <p>Mortise</p>
 <p>Buckle/Plastic box</p>	 <p>Cylinder/Key</p>	 <p>Screws/Tool</p>

■ Please Read the Manual |

- Any change submit to our confirmation.
- Any error or question in the manual, please feel free to contact us.
- It is forbidden to copy our manual and for other usage, except the authorized company and users.
- For any wrong operation or installation to the user or third party, Tenco does not responsible for the duty.
- For the damage caused by anthropic factor or inevitable reason, Tenco does not pay the loss or maintain for free, please check our after sale service terms.
- Please do not take apart the lock if you are not technician, if necessary, please make the operation under the guide of technician.
- Notice: There is maybe a little difference for product pictures with real goods, please subject to our real products.
- After changing the battery, please do not throw away them , kindly refund to recycle bin in case of pollution!



Phase 1 Summarization

Technical Parameters

Fingerprint Sensor:	Optical sensor, blue window/360 degree recognition
Main Parts:	Front/Back panel,mortise,buckle,cylinder,key
Master Fingerprint:	1pcs
User Fingerprint:	100pcs
Resolution:	500DPI
Reading Speed:	<1S
Static Current:	<25uA
Working Voltage:	DC4.5V~6v, 4pcs AA batteries
Battery Life:	15000 times
Working Temperature:	-20-55 degree
Unlock way:	Touch the fingerprint to the window, the blue light flash one time with one sound, turn the handle to open the door. if you do not open, it will lock after 5 seconds automatically.
Low voltage alarm:	if the power is less than 4.8v, there are 3 sounds for tip. you can still open 10 times. if it is less than 4.5v, you can not open the door any more.

Lock Part Description

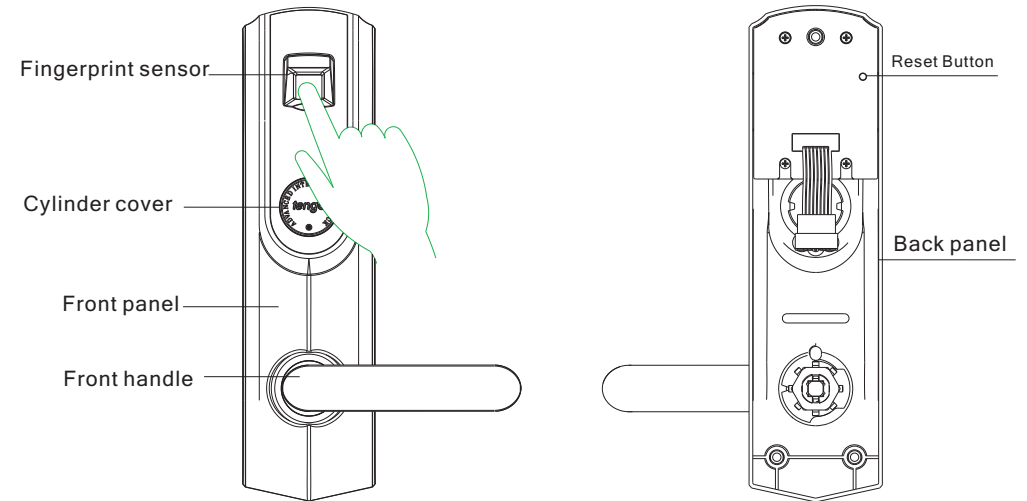

Phase 2 Installation Guide

1. Drill the Hole

We suggest you making the hole under the guide with manufacturer and the door factory, to avoid the mistake or damage to the doors.

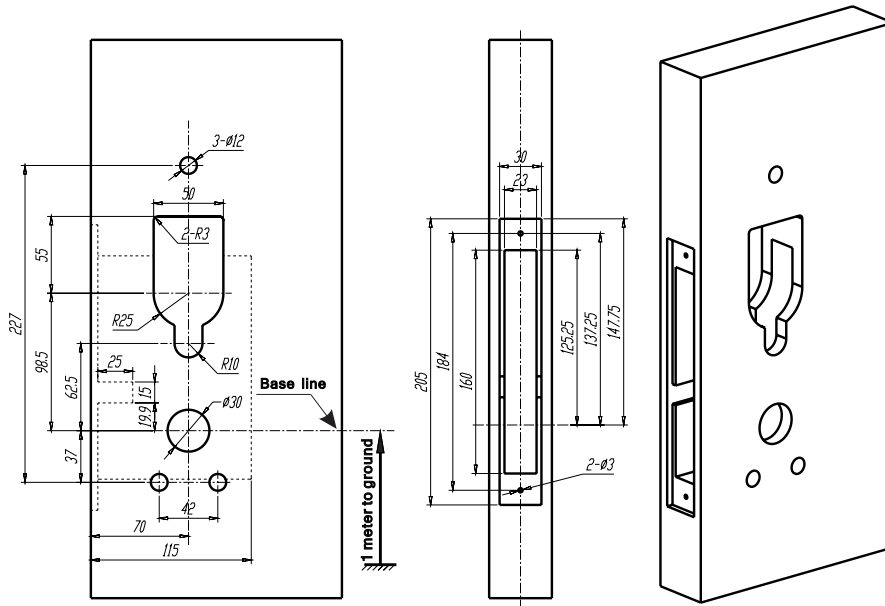

Pic(1)

2. Door frame drilling diagram

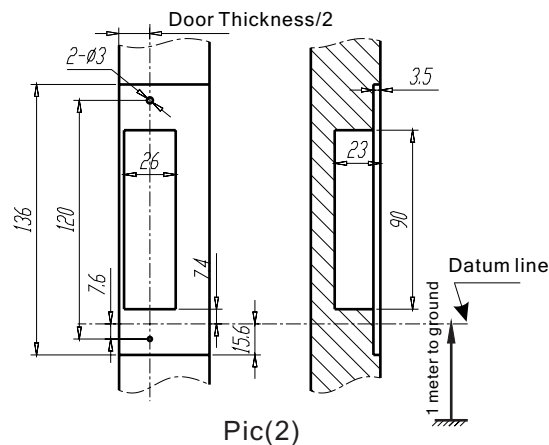

Pic(2)

3. Drill the hole: see the pic(3), please first draw one horizontal base line in the position of 1 meter to the ground, align the base line in the drill drawing with the drawn line and make the hole as the picture shows:

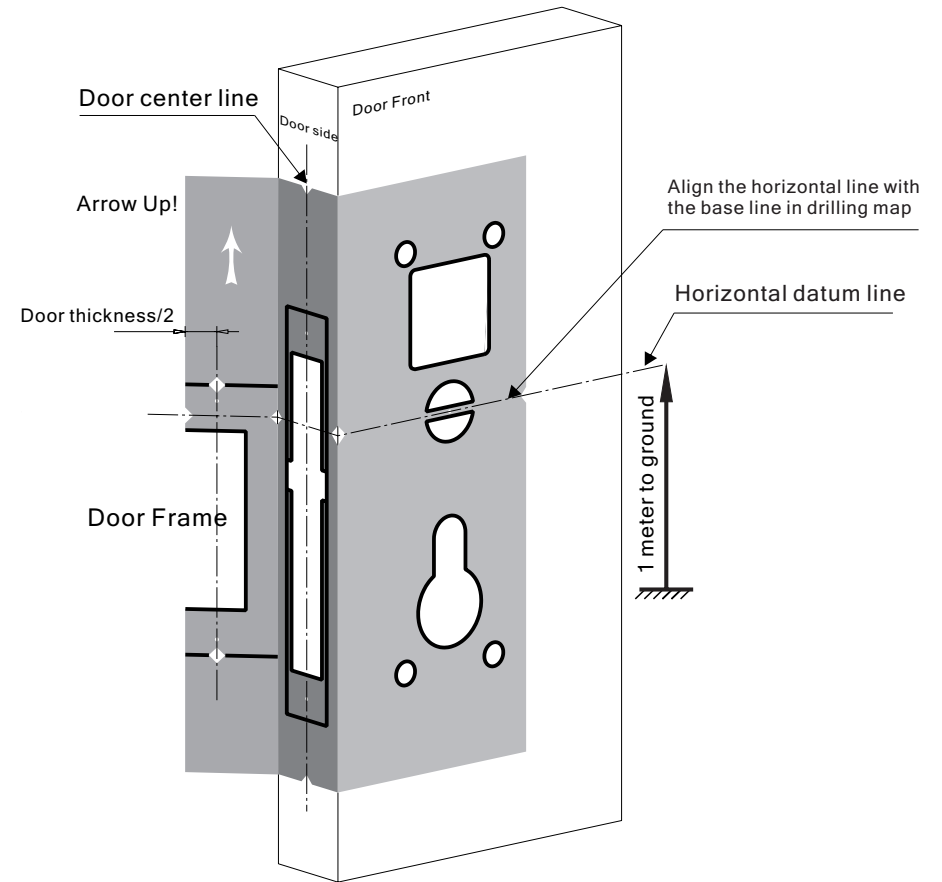

Pic(3) Drilling Sketch Map

4. Drill door frame: please drill the hole in the door frame as drawing. It is better to ask the technician to make the hole.

II. Door Lock Assembly

There are 3 steps for the mortise, cylinder and panel.
please follow our instruction or the guide of technician.

1. Exploded View of Assembly

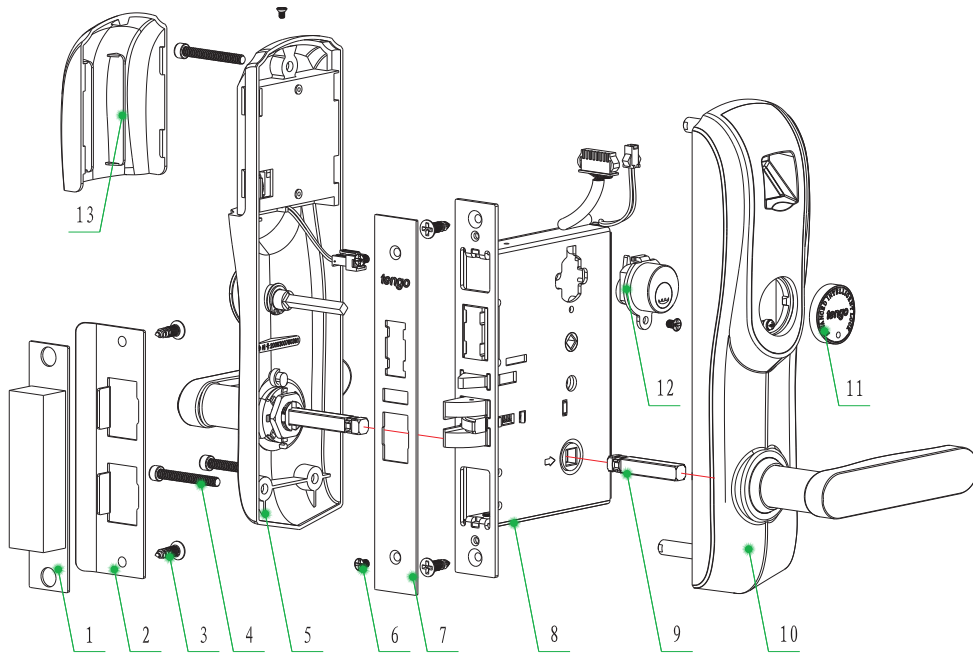

Pic(4) Assembly Exploded View

No.	Name	Qty.	No.	Name	Qty.
①	Buckle box	1	⑧	Mortise	1
②	Buckle	1	⑨	Latch	2
③	ST4x20 Cross sunk self-tapping screw	4	⑩	Front panel	1
④	M5x40 Hexagon socket cap screw	3	(11)	Logo cover	1
⑤	Back panel	1	(12)	Cylinder	1
⑥	M4x6 Cross sunk crew	3	(13)	Battery box	1
⑦	Side plate	1			

2. Mortise Installation

There are 3 types of mortises to use for different models. And different for left/right direction. Draw out the 8P connector out of the hole and fix the screws.

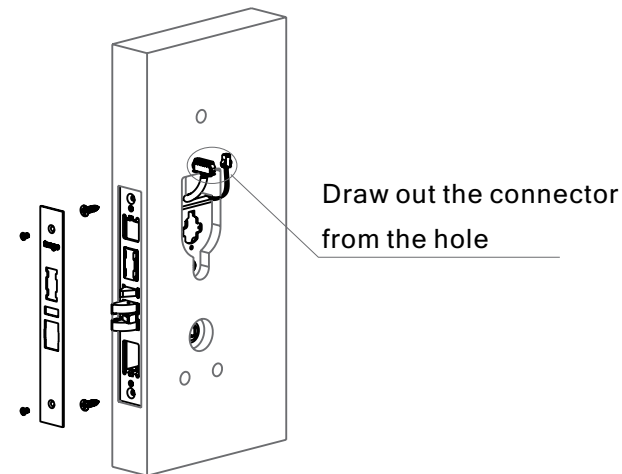
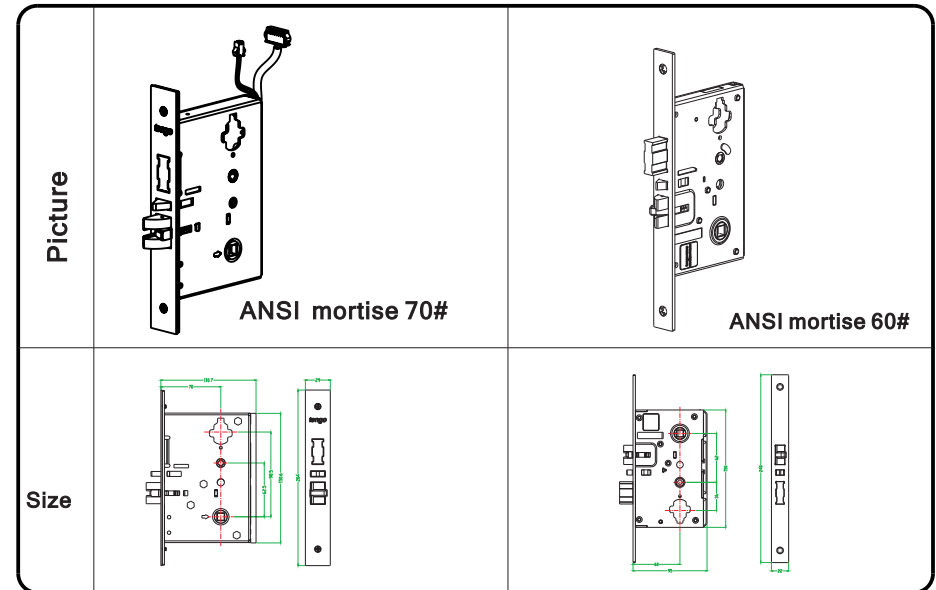

Pic(5) Install Mortise

3. Install the cylinder as the picture and fix the screws.

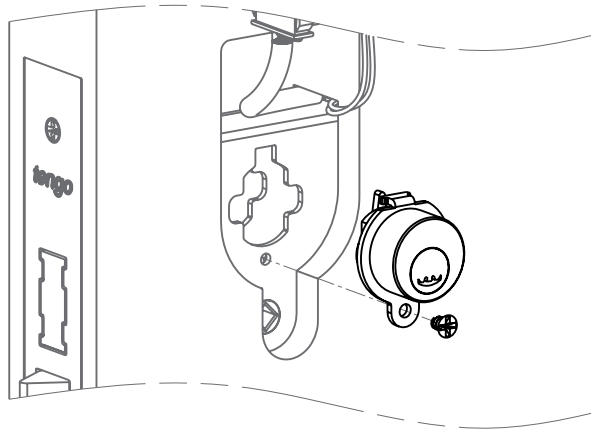

Pic(6) Install Cylinder

4. Latch assembly in front and back, check pic(8).

Remark: dot in the spindle shall align with the arrow in the mortise.

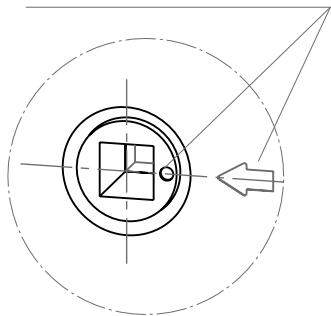

Pic(7) Dot/Arrow

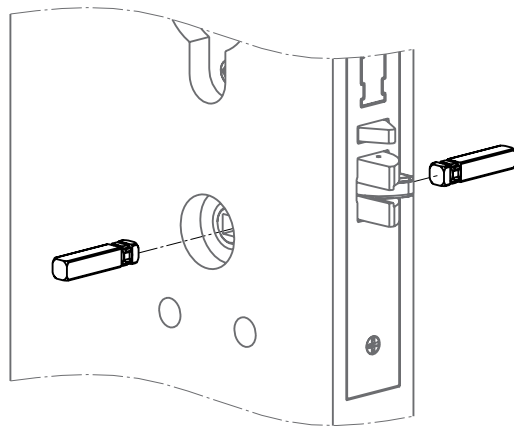

Pic(8) Install Latch

5. Front panel installation: connect the 8p connector as the picture, align the square latch and the handle hole, then fix the front panel on the door.

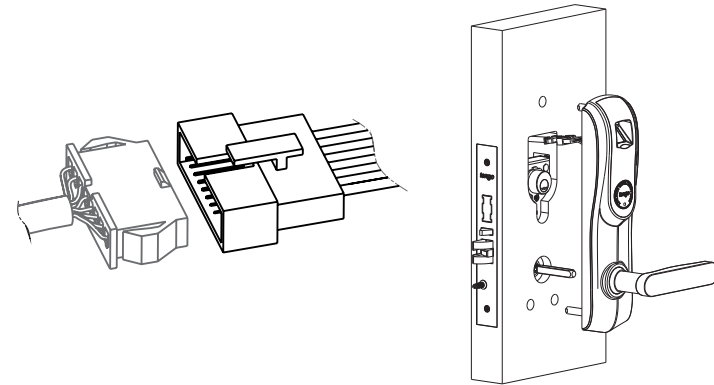

Pic(9) Install Front Panel

6. Back panel installation: Connect the 2p connector as the picture, align the latch and handle, fix the panel and the screws.

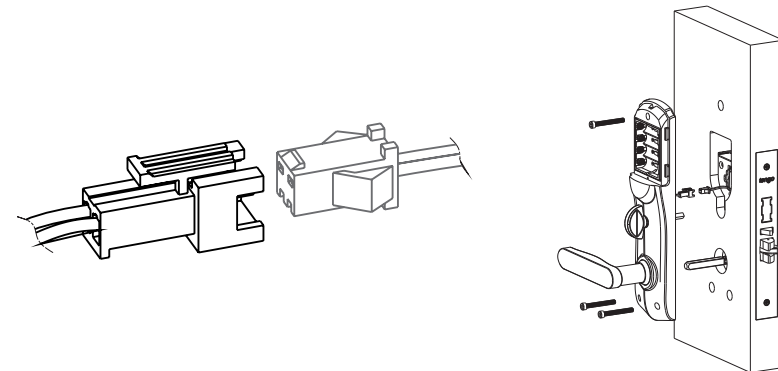

Pic(10) Install Back Panel

7. Battery and battery box installation as below picture:

Notice the anode and cathode of battery, or it will cause damage to the PCB and battery box.

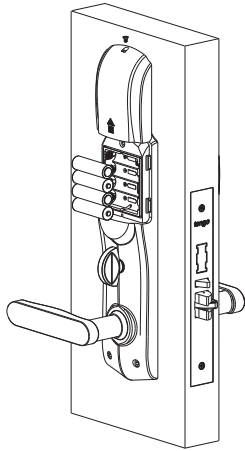

Pic(11) Install Battery Box

Phase 3 Operation Setting

Function Description

1. Factory State

Under factory state, there is no fingerprint memory inside, any fingerprint can open the door, after you set the master fingerprint, this function will be invalid.

2. Master fingerprint: It is to enroll and delete the user fingerprints.

3. User fingerprint: to open the door include the dead locking door.

3.1 Enroll Master Fingerprint

If the lock is under the factory state, just insert the mechanical key into the cylinder and turn the mechanical key to open the door with the blue light turns on, press one fingerprint on the sensor window, there is one short beep. Then press the same one fingerprint on the sensor window, with one long beep, you can enroll the master fingerprint successfully.

If the operation failed, there are three short beeps.

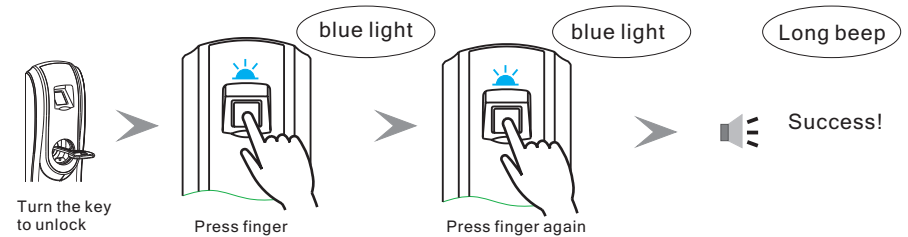

During the blue light flashes, please press another fingerprint to enroll as user fingerprint, there is one short beep. Then press the same one fingerprint on the sensor window, with one long beep, you can enroll the user fingerprint successfully.

If the operation failed, there are three short beeps.

If the operation is not right for three times or no operation within 5 seconds, the lock will exit the setting state automatically with two short beeps for tip.

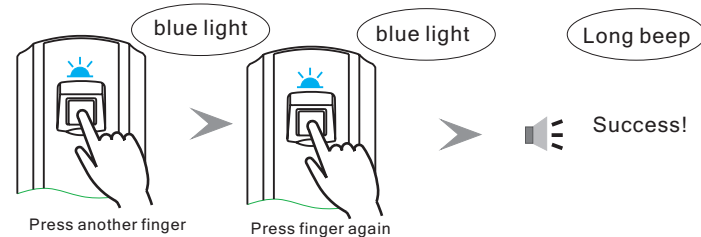

If the master fingerprint existed already, when you press your fingerprint on the sensor windows, there is beep-beep tips and red light flash. You can insert the mechanical key into the cylinder and turn the mechanical key to open the door with the blue light turns on, press the master fingerprint on the sensor window, there is one short beep. Then press another fingerprint on the sensor window for two times, each time there is one short beep. Then the new fingerprint will turn to the master fingerprint. The old user fingerprints that enrolled under the old master fingerprint will not work anymore.

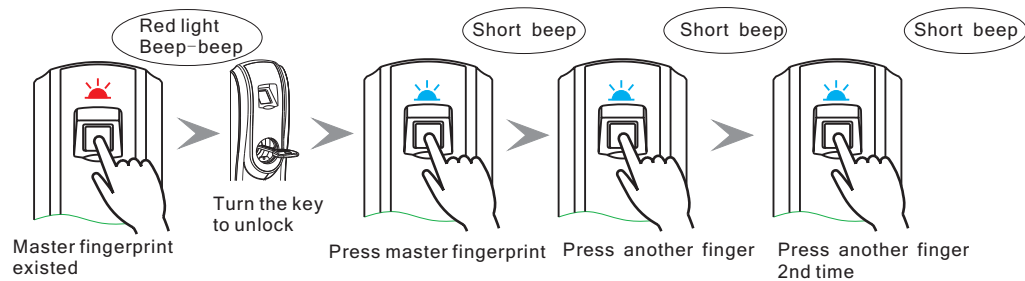

3.2 Add User Fingerprint

Press the master fingerprint on the sensor windows, there is one short beep with the blue light turns on (the lock will open too), press one fingerprint on the sensor window, there is one short beep. Then press the same one fingerprint on the sensor window, with one long beep, you can enroll the new under fingerprint successfully.

If the operation failed, there are three short beeps.

If the operation is not right for three times or no operation within 5 seconds, the lock will exit the setting state automatically with two short beeps for tip.

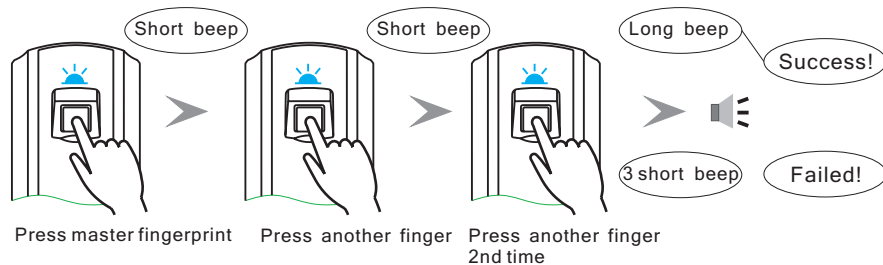

3.3 Delete One User Fingerprint

Press the master fingerprint for 3 times and one time the user fingerprint.

First press the master fingerprint on the fingerprint sensor window, the lock will open with the blue light turn on, then press the master fingerprint on the sensor again, the blue light will flash, then press the master fingerprint on the sensor for the third time, the red light turn on and blue light turn off, finally press one fingerprint that you want to delete, there is one long beep, that means the operation is successful, you can continue to delete other user fingerprint as

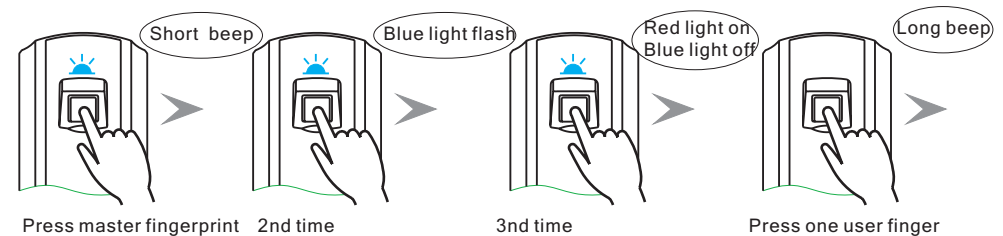

3.4 Always Open Function

First press the master fingerprint on the fingerprint sensor window, the lock will open with the blue light turn on, then press the lock latches(3 parts) for 5 seconds, there is one short beep, then press the master fingerprint on the sensor window, there is one long beep, then the lock will be under the always open state, that means you can depress the handle to open the door without pressing any fingerprints.

If you want to cancel this state, you can press the master fingerprint or any valid user fingerprint.

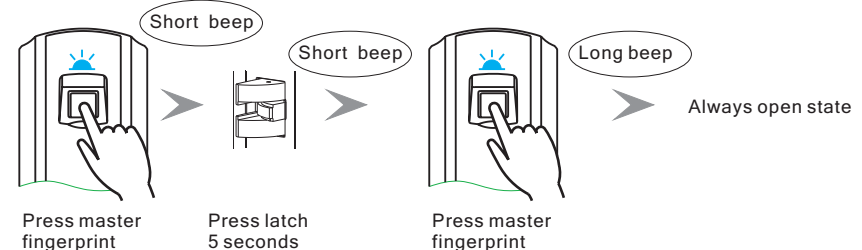

3.5 Delete All User Fingerprints

First press the master fingerprint on the fingerprint sensor window, the lock will open with the blue light turn on;

press the master fingerprint on the sensor again, the blue light will flash;

The third time you press the master fingerprint, the red light turn on but blue light turn off;

The fourth time you press the master fingerprint, the red light and blue light will turn on.

The fifth time you press the master fingerprint, the red light and blue light will flash with one long beep for tip.

Then all the user fingerprints will be deleted, only the master fingerprint is left. The lock will be under the setting state with the blue light turns on.

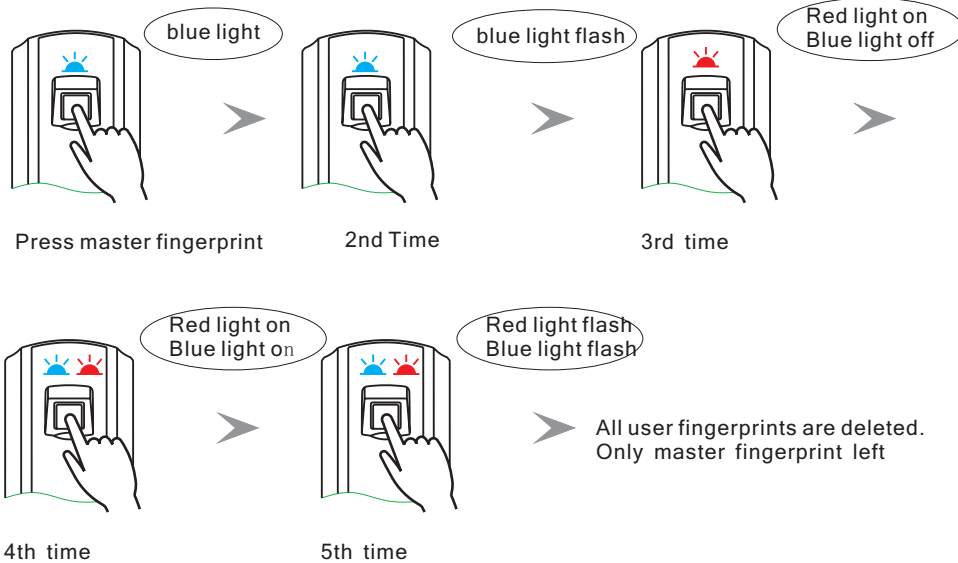

When the battery power is less than 4.8v, there is 3 long beeps when you press the fingerprint on the sensor windows. You can still open about 10 times. Please change the battery in time.

Usually the battery can last for one year up to the using frequency and conditions.

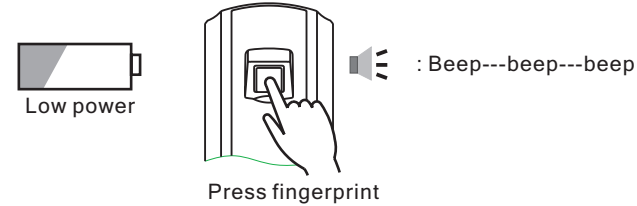

when the power is low:di-di-di with red light flash then green light. but you can still open 10 times, you need to change battery in time.the way to change battery is as below according to the models:

Warm tip: the lock shall use alkaline battery! or it will cause failure of lock.

Please refer the below picture to change the battery.

Notice the anode and cathode of battery to avoid the damage to the PCB.

